



3Dlite

convenience stroller

INSTRUCTION MANUAL

Please read the following instructions and warnings carefully before using the stroller. Keep this instruction manual for future reference. No tools required.

For Technical Support Call 1-800-268-6237

Keep small parts away from children.



WARNING:

Adult assembly required.
Exercise care when unpacking
and assembling product.



WARNING:

Read and follow all warnings and instructions.
Failure to do so could result in serious injury or death.

- Maximum weight of child: 50 lbs. (22.7 kg)
- **NEVER** leave child unattended.
- Avoid serious injury from falling or sliding out. **ALWAYS** use safety harness.
- When making adjustments to the product **ALWAYS ENSURE** that all parts of a child's body are clear of any moving parts of the product.
- Care must be taken when folding and unfolding the product to prevent finger entrapment.
- **DO NOT** carry additional children, goods or accessories in or on this product except as recommended in the manufacturer's instructions.
- **TO AVOID INJURY TO YOUR CHILD, DO NOT USE STORAGE BASKET AS A CHILD CARRIER.**
- **DO NOT** hang items on handle bar or place them on the canopy, as they can tip stroller over and injure child.
- **DO NOT OVERLOAD STORAGE BASKET. MAXIMUM 10 lbs. (4.5 kg).**
- **DO NOT** overload the storage pocket and cup holder. **MAXIMUM 2 lbs. (0.9 kg).** Excessive weight may cause the stroller to become unstable or tip over.
- Do not place hot liquids in the cup holder. Spills can burn your child.
- Do not carry or roll stroller on stairs or escalators with child in it.
- Do not use the strollers if any part is lost or damaged.
- See instructions for additional warnings.

components:

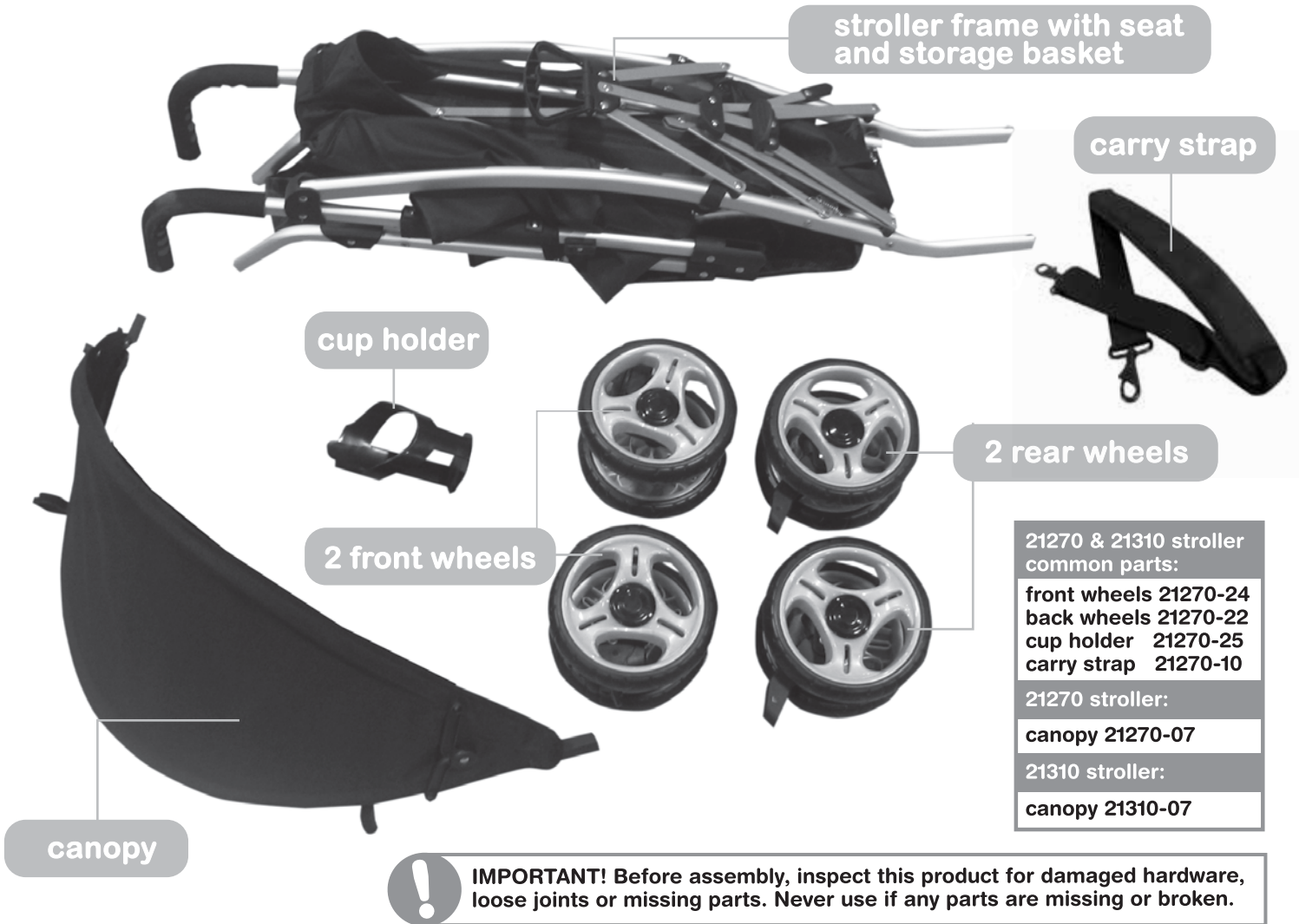

assembly instructions:

1 lift up fold-lock to release

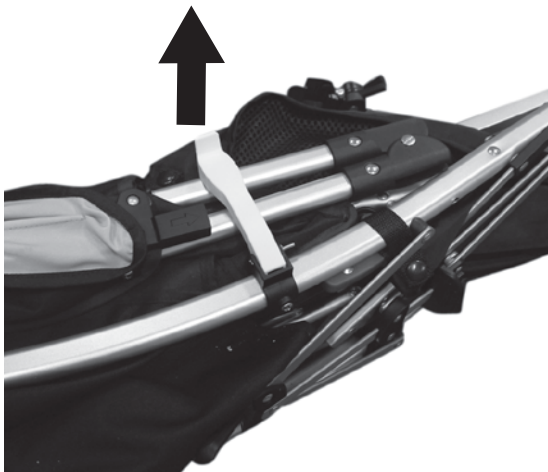

2 lift up to unfold



! NOTE: When opening the stroller, ensure that your child, or other children, are at a safe distance.

3 press the lock-out bar down with your foot



! NOTE: Before use, ensure that the stroller locking mechanism is secured.

4 align rear wheels and push onto frame



! Tug on each wheel to ensure they are both securely attached.

5 align front wheels making sure locations of lock pedal is up and push onto frame



! Tug on each wheel to ensure they are both securely attached.

6 line up cupholder with mounting post and push down

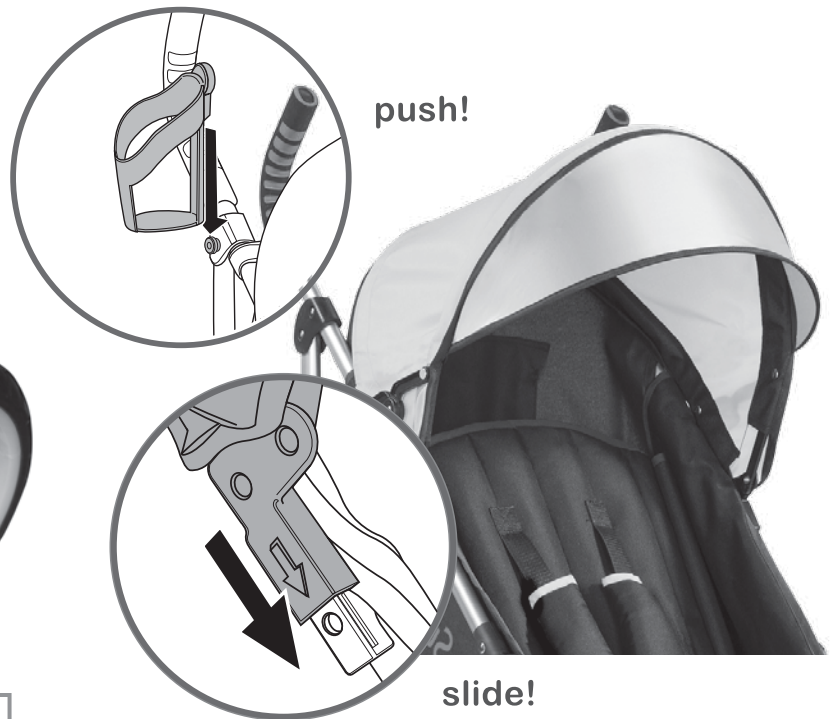

7 slide canopy onto frame mounts and attach velcro (both sides) **3**

components:



locking & unlocking canopy:

locking

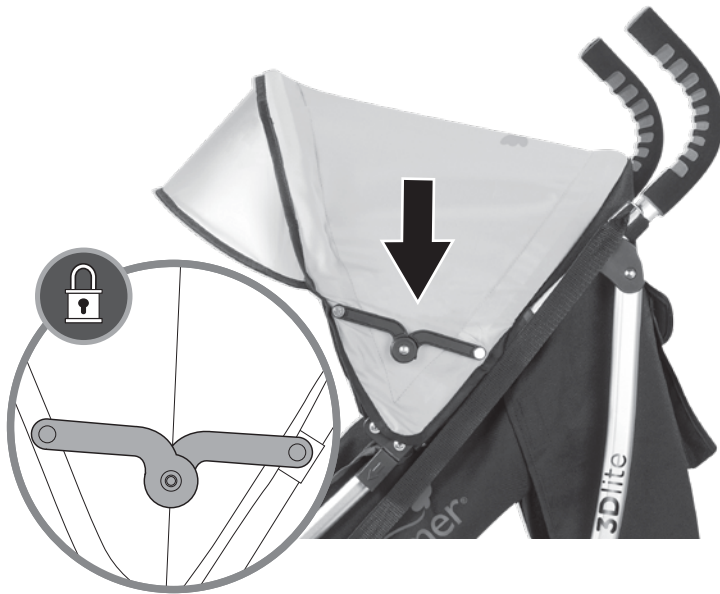

push down

unlocking

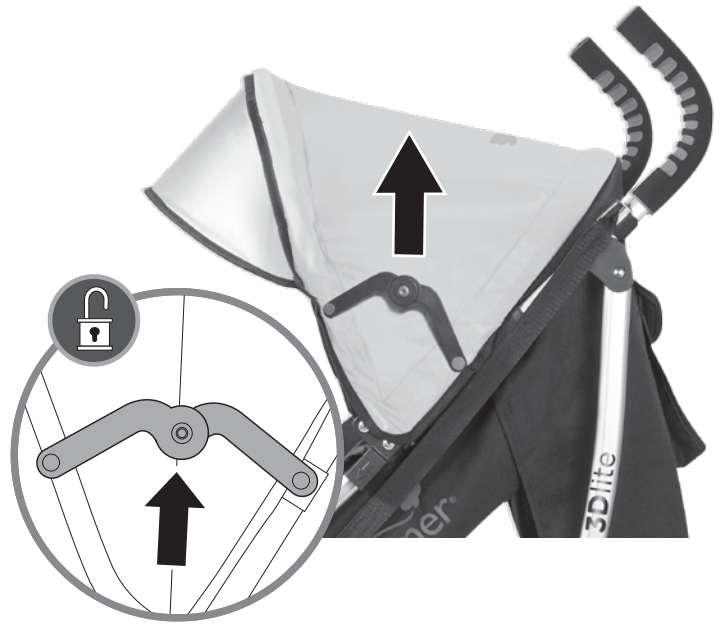

pull up

locking & unlocking wheels:

rear wheels - brake

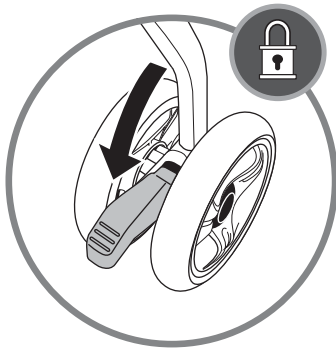

press button
down to lock
brake

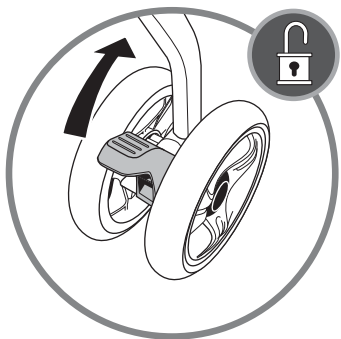

press button
up to unlock
brake

front wheels

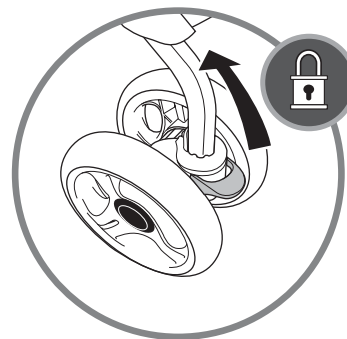

press button
up to lock
swivel

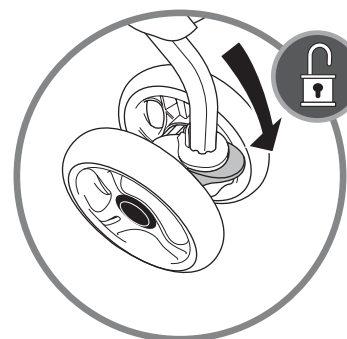

press button
down to unlock
swivel

reclining the seat:

1 to raise backrest up hold backrest and lift up to desired position



2 to lower backrest press red lever, lower backrest to desired position and lock in place



click!

4 positions

adjusting shoulder harness position:

remove harness pads, unlock restraint, slide shoulder harness out of slot, and adjust harness position as shown below and reinstall harness pads.

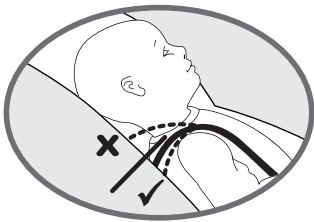

1 upper position!

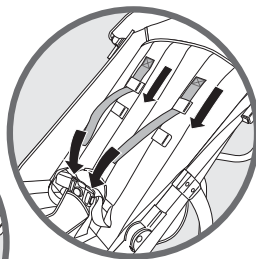

2 middle position!

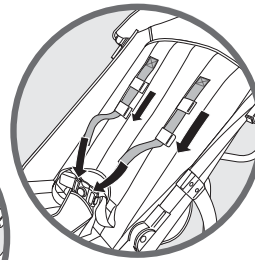

3 lower position!



locking/unlocking the child restraint:

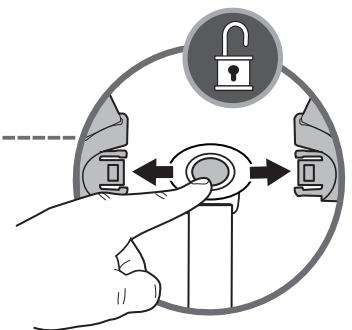
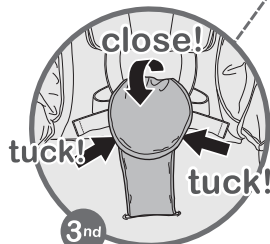
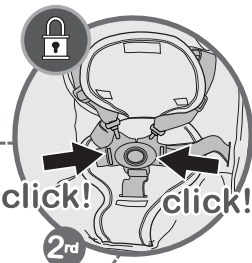
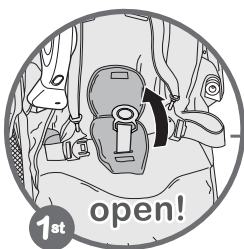

tightening and loosening child restraint:



slide to tighten

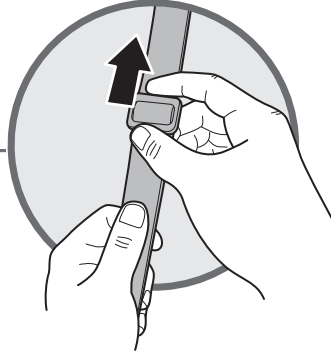

slide to loosen

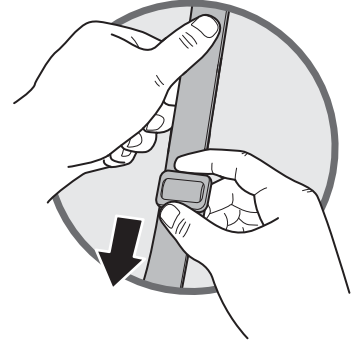

slide to tighten

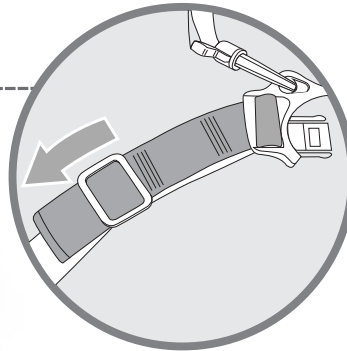

slide to loosen

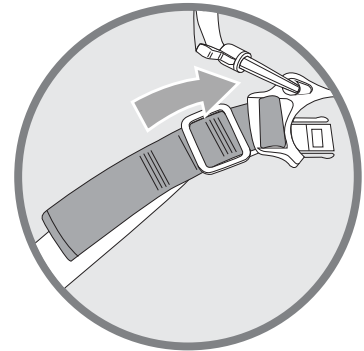

using sun visor:

flip visor out as shown,
tuck back under when not in use



folding your stroller:

1 unlock canopy



2 push safety lock lever down and pull up on the folding handle at the same time



3 push forward and down



4 throw over your shoulder and GO!



reattaching the storage basket:



care and maintenance:

- Clean minor stains on fabric with cold water and mild soap.
- Clean plastic and metal surfaces with a soft damp cloth. Air dry. Do not use abrasive cleaners or solvents. Do not use bleach.
- Check seat pad harness and crotch straps weekly to ensure they are properly secured to frame.



We **LOVE** our consumers!
Get to know us at:
www.summerinfant.com

Summer Infant stands behind all of its products. If you are not completely satisfied or have any questions, please contact our Consumer Relations Team at **1-800-268-6237** or www.summerinfant.com/contact
(For Europe call (0) 144 250 5000 or customerserviceuk@summerinfant.com)

connect with us:   

Summer Infant, Inc.
1275 Park East Drive
Woonsocket, RI 02895 USA
1-800-268-6237

Summer Infant Canada
11055 Middlegate Road, Unit 2
Mississauga, Ontario L4Y 3Y4

MADE IN CHINA.

©2012 Summer Infant, Inc.
Colors and styles may vary.
Please retain for future reference.